

SETTING OUT DATA-PROPOSED P43-3 ROAD UPGRADE
Lo 31 WGS 84

NAME	CH. (m)	Y-COORD. (m)	X-COORD. (m)	DETAILS
START	0.000	683.753	2620144.488	L 430.264m
BCC-1	430.264	1091.235	2620282.638	R 2000.000m
PI-1		1154.468	2620334.076	DA 3°49'30"
ECC-1	+563.751	1216.131	2620329.683	TL 66.768m AL 133.487m
BCC-2	2310.079	2828.914	2620999.452	R 500.000m
PI-2		2897.058	2621027.751	DA 16°47'20"
ECC-2	+2456.594	2970.471	2621035.160	TL 73.786m AL 146.515m
END	3200.000	3710.120	2621109.809	L 743.406m

- GENERAL NOTES:**
- ALL SETTING OUT DETAILS TO BE CHECKED ON SITE.
 - SERVICES TO BE RELOCATED WHERE NECESSARY IN CONSULTATION WITH THE SERVICE PROVIDERS.
 - SUBSOIL DRAINAGE TO BE PLACED IF NECESSARY AS DIRECTED BY THE ENGINEER.
 - DRAINAGE TO BE CHECKED ON SITE BEFORE ORDERING PIPES.
 - RECOMMENDED MINIMUM SLOPE OF PIPE CULVERTS TO BE 2%.
 - MINIMUM COVER OF 600mm FOR ALL PIPE CULVERTS.
 - PIPE CULVERT INVERT LEVELS TO BE CONFIRMED ON SITE.
 - ALL TYPE B3 ACCESSES HAVE A 8m RADIUS UNLESS OTHERWISE INDICATED.
 - THE POSITION OF ALL ACCESS POINTS TO BE VERIFIED ON SITE IN CONSULTATION WITH THE COMMUNITY.
 - ALL EXISTING PIPE CULVERTS THAT ARE NOT REQUIRED ARE TO BE REMOVED / EXCAVATED AND DISPOSED OF.
 - ALL NEW ROAD SIGNS AND ROADMARKING REQUIREMENTS ARE TO CONFORM TO THE SOUTH AFRICAN ROAD TRAFFIC SIGNS MANUAL (S.A.R.T.S.M).

LEGEND

- PROPOSED ROAD
- EXISTING TAR ROAD
- PROPOSED SPEED HUMP
- ROAD CROSS FALL
- STORMWATER EARTH CHANNEL
- SURVEY BENCHMARK
- 20YR FLOODLINE
- 50YR FLOODLINE

- ABBREVIATION**
- RD - ROAD
 - LP - LOW POINT
 - BNC - BEGINNING OF NORMAL CROWN
 - ENC - END OF NORMAL CROWN
 - HP - HIGH POINT
 - LC - LEVEL CROWN
 - BFS - BEGINNING OF FULL SUPER
 - EFS - END OF FULL SUPER
 - IL - INVERT LEVEL
 - EX - EXISTING
 - LVL - LEVEL
 - BW - BOTTOM WIDTH
 - TW - TOP WIDTH
 - D - DEPTH
 - TP - TRAPEZOIDAL

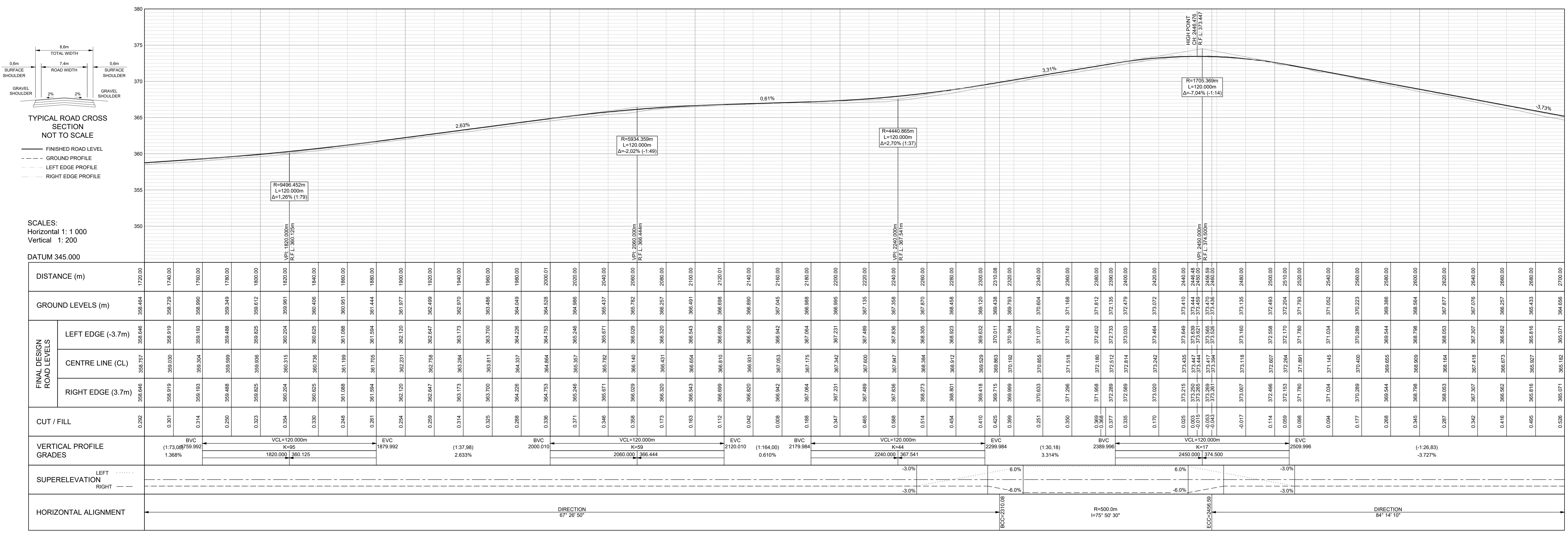

LONGSECTION PROPOSED P43-3 ROAD UPGRADE

No	DATE	REVISION 1	CONSULT	DIR
A	15-08-2019	PRELIMINARY DESIGN DRAWING	L.G.N	S.M.N

FOR PRELIMINARY

DESIGNED BY	SM NXUMALO (P. Technician)
CHECKED BY	LG NGCIBO (P. Technologist)
DRAWN BY	F BALOYI (Candidate Technician)
CHECKED BY	SM NXUMALO (P. Technician)

PALABORA COPPER (Pty) LIMITED

PO Box 65
1 Copper Road
1389
Phalaborwa, Limpopo

Tel: 015 780 2911
Fax: 015 780 2093

HLAYELENI CONSULTING ENGINEERS

12 BICCARD STREET
BICCARD HEIGHTS
OFFICE 17
POLOKWANE
0699

TEL: (015) 297 7434
FAX: (086) 244 8999

CLIENT	DATE
CONSULTING ENGINEER	DATE

PLM 00/2019

UPGRADING OF P43/3 ROAD
Ga-SELWANA ACCESS ROAD

ROAD LAYOUT PLAN AND LONG SECTION

SHEET 3 OF 4

CONSULTANTS	HCE 000/2019/103
DRAWING NUMBER	PLM 000/2019/103

SHEET **08** of **37**

AS SHOWN

CLIENT DRAWING NUMBER
PLM 000/2019/103